

Rahmen / 600-1

Parts list ErgoStrap 600
Frame - Cutter - Strap lifter

| Item | Quantity | Unit | Designation | Art. No. |
|--------|----------|------|---|----------|
| 1.1 | 1 | ea. | Frame with storage compartment (without attachment parts) 600 | 600100 |
| 1.2 | 2 | ea. | Large wheels (including disk + starlock-cap) | 600105 |
| 1.2.1 | 2 | ea. | Large wheels | 590001 |
| 1.2.2 | 3 | ea. | Washer | 590002 |
| 1.2.3 | 2 | ea. | Splint | 590003 |
| 1.3 | 2 | ea. | Front caster wheel (including screw connection) | 600104 |
| 1.3.1 | 2 | ea. | Front caster wheel | 590004 |
| 1.3.2 | 2 | ea. | Hexagonal recessed screw | 590005 |
| 1.3.3 | 2 | ea. | Hexagonal nut | 590006 |
| 1.4.1 | 1 | ea. | Strap lifter | 600106 |
| 1.4.2 | 1 | ea. | Hexagonal nut with clamp | 590007 |
| 1.4.3 | 2 | ea. | Plain bearing Ø 6,0 | 600110 |
| 1.4.4 | 2 | ea. | Plain bearing Ø 8,0 | 600111 |
| 1.4.5 | 2 | ea. | Covering cap | 590008 |
| 1.4.6 | 1 | ea. | Shrink-on tubing | 590009 |
| 1.4.7 | 1 | ea. | Sechskant screw | |
| 1.5.1 | 1 | ea. | Strut for strap lifter 600 | 600101 |
| 1.5.2 | 1 | ea. | Hexagonal recessed screw | 590010 |
| 1.5.3 | 2 | ea. | Hexagonal nut with clamp | 590011 |
| 1.5.4 | 1 | ea. | Roller | 590012 |
| 1.5.5 | 2 | ea. | Clips bearing Ø 6,0 | 600112 |
| 1.5.6 | 1 | ea. | Hexagonal recessed screw | 590013 |
| 1.6 | 1 | ea. | Foot lever for cutter (including screw connection) | 200011 |
| 1.6.1 | 1 | ea. | Foot lever for cutter | 190001 |
| 1.6.2 | 1 | ea. | Welded screw | 190002 |
| 1.6.3 | 1 | ea. | Washer | 190003 |
| 1.6.4 | 1 | ea. | Hexagonal nut with clamp | 190004 |
| 1.6.5 | 1 | ea. | Hexagonal screw | |
| 1.6.6 | 1 | ea. | Hexagonal nut | |
| 1.7.1 | 1 | ea. | Lifting mechanism for cutter | 200012 |
| 1.7.2 | 2 | ea. | Yoke | 190006 |
| 1.7.3 | 2 | ea. | Hexagonal nut | 190007 |
| 1.7.4 | 2 | ea. | Alignment bolts | 190008 |
| 1.7.5 | 2 | ea. | Safety plate | 190009 |
| | 1 | ea. | Art. 190007+190008+190009 | 200013 |
| 1.8 | 1 | ea. | Cutting knife (complete) | 200005 |
| 1.8.1 | 1 | ea. | Cutting knife | 200005 |
| 1.8.2 | 1 | ea. | Lever for cutting knife | 200015 |
| 1.8.3 | 1 | ea. | Threaded bolt delivery only with art. 200005 | 190011 |
| 1.9.1 | 1 | ea. | Holder for cutting knife | 200008 |
| 1.9.2 | 1 | ea. | Casing for cutting knife | 200004 |
| 1.9.3 | 1 | ea. | Compression spring for cutter with foot lever | 200014 |
| 1.9.4 | 2 | ea. | Cheese headed screw with slot | 190012 |
| 1.9.5 | 2 | ea. | Hexagonal nut | 593005 |
| 1.9.6 | 4 | ea. | Washer | 190014 |
| 1.9.7 | 1 | ea. | Hexagonal recessed screw | 190015 |
| 1.10.1 | 1 | ea. | Lower guide roller | 600107 |
| 1.10.2 | 2 | ea. | Hexagonal screw | 590014 |
| 1.10.3 | 2 | ea. | Hexagonal nut | 590015 |

Parts list ErgoStrap 600
Storage plates with drive

| Item | Quantity | Unit | Designation | Art. No. |
|--------|----------|------|--|----------|
| 2.1 | 1 | ea. | Storage plate strap side | 600113 |
| 2.2 | 1 | ea. | Storage plate with handle (operator side) | 600114 |
| 2.3.1 | 14 | ea. | Spacer sleeve | 600132 |
| 2.3.2 | 12 | ea. | Hexagonal recessed screw | 591001 |
| 2.3.3 | 4 | ea. | Hexagonal recessed screw | 591002 |
| 2.3.4 | 11 | ea. | Washer | 591003 |
| 2.3.5 | 14 | ea. | Hexagonal nut with flange | 593010 |
| 2.3.6 | 2 | ea. | Hexagonal nut with clamp | 591006 |
| 2.3.7 | 1 | ea. | Spacer strip | 600130 |
| 2.4.1 | 1 | ea. | Steel sprocket 600 | 600198 |
| 2.4.2 | 1 | ea. | Shaft with bore 600 | 600197 |
| 2.4.3 | 1 | ea. | Crank | 600117 |
| 2.4.4 | 1 | ea. | Sloted achsle | 591007 |
| 2.4.5 | 1 | ea. | Guide bolts for sprocket | 591008 |
| 2.4.6 | 1 | ea. | Plain bearing 600E | 600331 |
| 2.5 | 1 | ea. | Length stop strap with buffer (complete) | 700122 |
| 2.5.1 | 1 | ea. | Length stop strap | 600152 |
| 2.5.2 | 1 | ea. | Buffer block | 700155 |
| 2.5.3 | 2 | ea. | Cylinder screw with slot | 591009 |
| 2.5.4 | 2 | ea. | Hexagonal nut, flat type | 591010 |
| 2.5.5 | 1 | ea. | Buffer strap | 591011 |
| 2.7.1 | 1 | ea. | Hollow shaft for holding the packaging strap | 600120 |
| 2.7.2 | 1 | ea. | Hexagonal recessed screw | 591012 |
| 2.7.3 | 1 | ea. | Washer | 591013 |
| 2.7.4 | 1 | ea. | Disk, polyurethane, red, adjustable 76-407mm | 600148 |
| 2.7.5 | 3 | ea. | Threaded sleeve | 591014 |
| 2.7.6 | 6 | ea. | Washer | 591015 |
| 2.7.7 | 3 | ea. | Hexagonal screw | 591016 |
| 2.7.8 | 1 | ea. | Brake block for strap brake | 600125 |
| 2.7.9 | 1 | ea. | Compression spring for strap brake | 600126 |
| 2.7.10 | 1 | ea. | Threaded piece | 591017 |
| 2.7.11 | 1 | ea. | Adjustment screw for strap brake | 600127 |
| 2.7.12 | 1 | ea. | Spacer 12mm, for distributing strap take-up | 600190 |
| 2.7.13 | 1 | ea. | Guide pulley, upper without groove | 600206 |
| 2.7.14 | 1 | ea. | Axle for guide pulley, upper | 600196 |
| 2.7.15 | 1 | ea. | Flashing for guide pulley, upper with groove | 600208 |
| 2.7.16 | 1 | ea. | Guide pulley, upper with groove | 600207 |
| 2.7.17 | 2 | ea. | Hexagonal recessed screw * | 591018 |
| 2.7.18 | 2 | ea. | Washer * | 591019 |
| 2.7.19 | 2 | ea. | Hexagonal nut * | 591010 |
| 2.7.20 | 1 | ea. | Strap guiding pin | 600119 |

*) only for guide pulley with groove (Item 2.7.16)

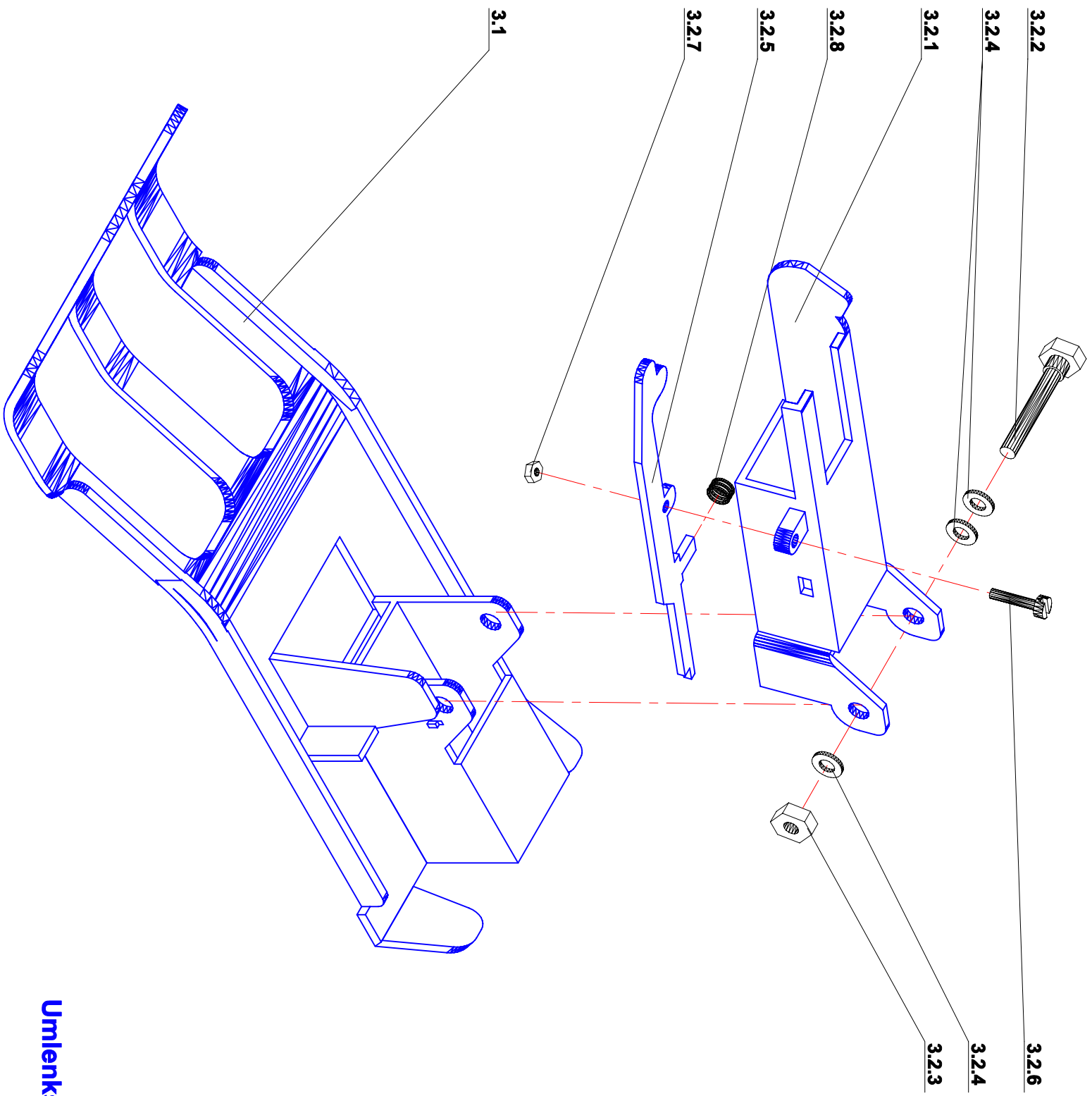

Parts list ErgoStrap 600
Reversing sledge

| Item | Quantity | Unit | Designation | Art. No. |
|-------------|-----------------|-------------|--|-----------------|
| 3.1 | 1 | ea. | Support shoe/skid | 600155 |
| 3.2.1 | 1 | ea. | Support-movable part | 600154 |
| 3.2.2 | 1 | ea. | Hexagonal screw | 592001 |
| 3.2.3 | 1 | ea. | Hexagonal nut with clamp | 592002 |
| 3.2.4 | 2 | ea. | Washer | 592003 |
| 3.2.5 | 1 | ea. | Lever, guide pulley support | 600156 |
| 3.2.6 | 1 | ea. | Hexagonal recessed screw | 592004 |
| 3.2.7 | 1 | ea. | Hexagonal nut with clamp | 592005 |
| 3.2.8 | 1 | ea. | Compression spring for lever, guide pulley support | 600157 |

Parts list ErgoStrap 600
ChainLance

| Item | Quantity | Unit | Designation | Art. No. |
|-------------|-----------------|-------------|-------------------------------|-----------------|
| 4.1 | 1 | ea. | Header (complete) | 600135 |
| 4.1.1 | 1 | ea. | Header | 600149 |
| 4.1.2 | 1 | ea. | Cam | 600143 |
| 4.1.3 | 1 | ea. | Cam axle | 593001 |
| 4.1.4 | 1 | ea. | Trip pin for cam | 593002 |
| 4.2 | 1 | ea. | ChainLance, complete 600 | 600137 |
| 4.2.1 | 1 | ea. | Chain link, number 1 | 600136 |
| 4.2.2 | 142 | ea. | Chain link, number 2 | 600153 |
| 4.2.3 | 1 | ea. | Chain link, number 3 | 600209 |
| 4.2.4 | 1 | ea. | Chain link, number 4 | 600138 |
| 4.3 | 1 | ea. | Chain link, number 5 complete | 600210 |
| 4.3.1 | 1 | ea. | Chain link, number 5 | 593003 |
| 4.3.2 | 1 | ea. | Bufferblock | 600151 |
| 4.3.3 | 2 | ea. | Cylinderscrew with slot | 593004 |
| 4.3.4 | 2 | ea. | Hexagonal nut | 593005 |